

GN 288 | Pivoting connecting clamps

Aluminium



- 1
- 2
- 3
- 4
- 5
- 6
- 7
- 8
- 9
- 10
- 11
- 12
- 13
- 14
- 15
- 16
- 17
- 18

MATERIAL

Aluminium, matte finish.
AISI 304 stainless steel screws and nuts.

STANDARD EXECUTIONS

- **GN 288-BL-S**: natural aluminium, with continuous adjustment.
- **GN 288-BL-T**: natural aluminium, with adjustment by 15° snaps.
- **GN 288-SW-S**: aluminium, epoxy resin coating, RAL 9005 black colour, with continuous adjustment.
- **GN 288-SW-T**: aluminium, epoxy resin coating, RAL 9005 black colour, with adjustment by 15° snaps.

FEATURES AND APPLICATIONS

The assembly hole of GN 288 connecting clamps allows an excellent match with tubes GN 990 (see page 1954).

GN 288 connecting clamps are an assembly of connecting clamps GN 276 (see page 1934) and GN 278 (see page 1936).

The clamping screws d3 and d4 may be replaced by clamping kit GN 911 (see page 1958).

SPECIAL EXECUTIONS ON REQUEST

Different combinations of holes d1/d2.

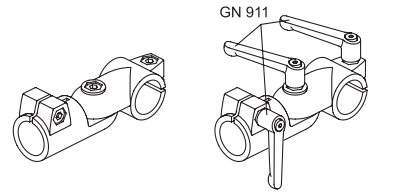

Conversion Table 1 mm = 0.039 inch			
d1			
mm	inch	mm	inch
20	0.79	42	1.65
25	0.98	45	1.77
30	1.18	48	1.89
40	1.57	50	1.97

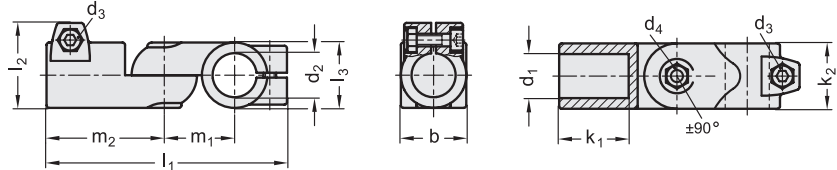

METRIC

Code BL	Code SW	Description	b	d1	d2	d3	d4	k1	k2	l1	l2	l3	m1	m2	d3 Clamping kit	d4 Clamping kit	⚖️
GN.64811	GN.64816	GN 288-B20-B20-S-2*	40	20	20	M8	M8	42.5	40	147	52	40	43	72	GN 911-M8-32	GN 911-M8-35	410
GN.64851	GN.64856	GN 288-B20-B25-S-2*	40	20	25	M8	M8	42.5	40	147	52	40	43	72	GN 911-M8-32	GN 911-M8-35	410
GN.64891	GN.64896	GN 288-B20-B30-S-2*	40	20	30	M8	M8	42.5	40	147	52	40	43	72	GN 911-M8-32	GN 911-M8-35	345
GN.64931	GN.64936	GN 288-B25-B20-S-2*	40	25	20	M8	M8	42.5	40	147	52	40	43	72	GN 911-M8-32	GN 911-M8-35	375
GN.64971	GN.64976	GN 288-B25-B25-S-2*	40	25	25	M8	M8	42.5	40	147	52	40	43	72	GN 911-M8-32	GN 911-M8-35	375
GN.65011	GN.65016	GN 288-B25-B30-S-2*	40	25	30	M8	M8	42.5	40	147	52	40	43	72	GN 911-M8-32	GN 911-M8-35	375
GN.65051	GN.65056	GN 288-B30-B20-S-2*	40	30	20	M8	M8	42.5	40	147	52	40	43	72	GN 911-M8-32	GN 911-M8-35	325
GN.65091	GN.65096	GN 288-B30-B25-S-2*	40	30	25	M8	M8	42.5	40	147	52	40	43	72	GN 911-M8-32	GN 911-M8-35	340
GN.65131	GN.65136	GN 288-B30-B30-S-2*	40	30	30	M8	M8	42.5	40	147	52	40	43	72	GN 911-M8-32	GN 911-M8-35	325
GN.65171	GN.65176	GN 288-B40-B40-S-2*	65	40	40	M10	M10	74	65	230	77.5	65	70	115	GN 911-M10M55	GN 911-M10-63	1500
GN.65211	GN.65216	GN 288-B40-B42-S-2*	65	40	42	M10	M10	74	65	230	77.5	65	70	115	GN 911-M10M55	GN 911-M10-63	1510
GN.65251	GN.65256	GN 288-B40-B45-S-2*	65	40	45	M10	M10	74	65	230	77.5	65	70	115	GN 911-M10M55	GN 911-M10-63	1500
GN.65291	GN.65296	GN 288-B40-B48-S-2*	65	40	48	M10	M10	74	65	230	77.5	65	70	115	GN 911-M10M55	GN 911-M10-63	1500
GN.65331	GN.65336	GN 288-B40-B50-S-2*	65	40	50	M10	M10	74	65	230	77.5	65	70	115	GN 911-M10M55	GN 911-M10-63	1490
GN.65371	GN.65376	GN 288-B42-B40-S-2*	65	42	40	M10	M10	74	65	230	77.5	65	70	115	GN 911-M10M55	GN 911-M10-63	1470
GN.65411	GN.65416	GN 288-B42-B42-S-2*	65	42	42	M10	M10	74	65	230	77.5	65	70	115	GN 911-M10M55	GN 911-M10-63	1465
GN.65451	GN.65456	GN 288-B42-B45-S-2*	65	42	45	M10	M10	74	65	230	77.5	65	70	115	GN 911-M10M55	GN 911-M10-63	1460
GN.65491	GN.65496	GN 288-B42-B48-S-2*	65	42	48	M10	M10	74	65	230	77.5	65	70	115	GN 911-M10M55	GN 911-M10-63	1455
GN.65531	GN.65536	GN 288-B42-B50-S-2*	65	42	50	M10	M10	74	65	230	77.5	65	70	115	GN 911-M10M55	GN 911-M10-63	1450
GN.65571	GN.65576	GN 288-B45-B40-S-2*	65	45	40	M10	M10	74	65	230	77.5	65	70	115	GN 911-M10M55	GN 911-M10-63	1410
GN.65611	GN.65616	GN 288-B45-B42-S-2*	65	45	42	M10	M10	74	65	230	77.5	65	70	115	GN 911-M10M55	GN 911-M10-63	1405
GN.65651	GN.65656	GN 288-B45-B45-S-2*	65	45	45	M10	M10	74	65	230	77.5	65	70	115	GN 911-M10M55	GN 911-M10-63	1400
GN.65691	GN.65696	GN 288-B45-B48-S-2*	65	45	48	M10	M10	74	65	230	77.5	65	70	115	GN 911-M10M55	GN 911-M10-63	1395
GN.65731	GN.65736	GN 288-B45-B50-S-2*	65	45	50	M10	M10	74	65	230	77.5	65	70	115	GN 911-M10M55	GN 911-M10-63	1390
GN.65771	GN.65776	GN 288-B48-B40-S-2*	65	48	40	M10	M10	74	65	230	77.5	65	70	115	GN 911-M10M55	GN 911-M10-63	1270
GN.65811	GN.65816	GN 288-B48-B42-S-2*	65	48	42	M10	M10	74	65	230	77.5	65	70	115	GN 911-M10M55	GN 911-M10-63	1265
GN.65851	GN.65856	GN 288-B48-B45-S-2*	65	48	45	M10	M10	74	65	230	77.5	65	70	115	GN 911-M10M55	GN 911-M10-63	1260
GN.65891	GN.65896	GN 288-B48-B48-S-2*	65	48	48	M10	M10	74	65	230	77.5	65	70	115	GN 911-M10M55	GN 911-M10-63	1300
GN.65931	GN.65936	GN 288-B48-B50-S-2*	65	48	50	M10	M10	74	65	230	77.5	65	70	115	GN 911-M10M55	GN 911-M10-63	1295
GN.65971	GN.65976	GN 288-B50-B40-S-2*	65	50	40	M10	M10	74	65	230	77.5	65	70	115	GN 911-M10M55	GN 911-M10-63	1275
GN.66011	GN.66016	GN 288-B50-B42-S-2*	65	50	42	M10	M10	74	65	230	77.5	65	70	115	GN 911-M10M55	GN 911-M10-63	1275
GN.66051	GN.66056	GN 288-B50-B45-S-2*	65	50	45	M10	M10	74	65	230	77.5	65	70	115	GN 911-M10M55	GN 911-M10-63	1270
GN.66091	GN.66096	GN 288-B50-B48-S-2*	65	50	48	M10	M10	74	65	230	77.5	65	70	115	GN 911-M10M55	GN 911-M10-63	1265
GN.66131	GN.66136	GN 288-B50-B50-S-2*	65	50	50	M10	M10	74	65	230	77.5	65	70	115	GN 911-M10M55	GN 911-M10-63	1275

* Complete the description of the standard item needed by adding the finish of the connector clamps: BL (blank) or SW (black).



Conversion Table 1 mm = 0.039 inch			
d1			
mm	inch	mm	inch
20	0.79	42	1.65
25	0.98	45	1.77
30	1.18	48	1.89
40	1.57	50	1.97

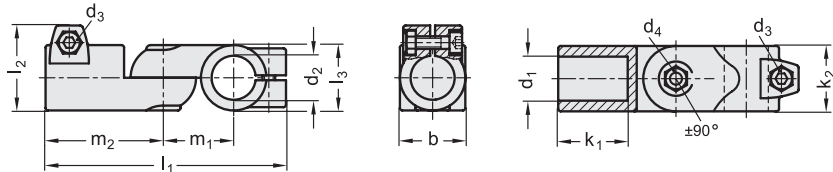

METRIC

Code BL	Code SW	Description	b	d1	d2	d3	d4	k1	k2	l1	l2	l3	m1	m2	d3 Clamping kit	d4 Clamping kit	⚖️
GN.64831	GN.64836	GN 288-B20-B20-T-2-*	40	20	20	M8	M8	42.5	40	147	52	40	43	72	GN 911-M8-32	GN 911-M8-35	420
GN.64871	GN.64876	GN 288-B20-B25-T-2-*	40	20	25	M8	M8	42.5	40	147	52	40	43	72	GN 911-M8-32	GN 911-M8-35	410
GN.64911	GN.64916	GN 288-B20-B30-T-2-*	40	20	30	M8	M8	42.5	40	147	52	40	43	72	GN 911-M8-32	GN 911-M8-35	420
GN.64951	GN.64956	GN 288-B25-B20-T-2-*	40	25	20	M8	M8	42.5	40	147	52	40	43	72	GN 911-M8-32	GN 911-M8-35	380
GN.64991	GN.64996	GN 288-B25-B25-T-2-*	40	25	25	M8	M8	42.5	40	147	52	40	43	72	GN 911-M8-32	GN 911-M8-35	380
GN.65031	GN.65036	GN 288-B25-B30-T-2-*	40	25	30	M8	M8	42.5	40	147	52	40	43	72	GN 911-M8-32	GN 911-M8-35	380
GN.65071	GN.65076	GN 288-B30-B20-T-2-*	40	30	20	M8	M8	42.5	40	147	52	40	43	72	GN 911-M8-32	GN 911-M8-35	325
GN.65111	GN.65116	GN 288-B30-B25-T-2-*	40	30	25	M8	M8	42.5	40	147	52	40	43	72	GN 911-M8-32	GN 911-M8-35	340
GN.65151	GN.65156	GN 288-B30-B30-T-2-*	40	30	30	M8	M8	42.5	40	147	52	40	43	72	GN 911-M8-32	GN 911-M8-35	330
GN.65191	GN.65196	GN 288-B40-B40-T-2-*	65	40	40	M10	M10	74	65	230	77.5	65	70	115	GN 911-M10M55	GN 911-M10-63	1510
GN.65231	GN.65236	GN 288-B40-B42-T-2-*	65	40	42	M10	M10	74	65	230	77.5	65	70	115	GN 911-M10M55	GN 911-M10-63	1510
GN.65271	GN.65276	GN 288-B40-B45-T-2-*	65	40	45	M10	M10	74	65	230	77.5	65	70	115	GN 911-M10M55	GN 911-M10-63	1500
GN.65311	GN.65316	GN 288-B40-B48-T-2-*	65	40	48	M10	M10	74	65	230	77.5	65	70	115	GN 911-M10M55	GN 911-M10-63	1500
GN.65351	GN.65356	GN 288-B40-B50-T-2-*	65	40	50	M10	M10	74	65	230	77.5	65	70	115	GN 911-M10M55	GN 911-M10-63	1490
GN.65391	GN.65396	GN 288-B42-B40-T-2-*	65	42	40	M10	M10	74	65	230	77.5	65	70	115	GN 911-M10M55	GN 911-M10-63	1470
GN.65431	GN.65436	GN 288-B42-B42-T-2-*	65	42	42	M10	M10	74	65	230	77.5	65	70	115	GN 911-M10M55	GN 911-M10-63	1475
GN.65471	GN.65476	GN 288-B42-B45-T-2-*	65	42	45	M10	M10	74	65	230	77.5	65	70	115	GN 911-M10M55	GN 911-M10-63	1460
GN.65511	GN.65516	GN 288-B42-B48-T-2-*	65	42	48	M10	M10	74	65	230	77.5	65	70	115	GN 911-M10M55	GN 911-M10-63	1455
GN.65551	GN.65556	GN 288-B42-B50-T-2-*	65	42	50	M10	M10	74	65	230	77.5	65	70	115	GN 911-M10M55	GN 911-M10-63	1450
GN.65591	GN.65596	GN 288-B45-B40-T-2-*	65	45	40	M10	M10	74	65	230	77.5	65	70	115	GN 911-M10M55	GN 911-M10-63	1410
GN.65631	GN.65636	GN 288-B45-B42-T-2-*	65	45	42	M10	M10	74	65	230	77.5	65	70	115	GN 911-M10M55	GN 911-M10-63	1405
GN.65671	GN.65676	GN 288-B45-B45-T-2-*	65	45	45	M10	M10	74	65	230	77.5	65	70	115	GN 911-M10M55	GN 911-M10-63	1400
GN.65711	GN.65716	GN 288-B45-B48-T-2-*	65	45	48	M10	M10	74	65	230	77.5	65	70	115	GN 911-M10M55	GN 911-M10-63	1395
GN.65751	GN.65756	GN 288-B45-B50-T-2-*	65	45	50	M10	M10	74	65	230	77.5	65	70	115	GN 911-M10M55	GN 911-M10-63	1390
GN.65791	GN.65796	GN 288-B48-B40-T-2-*	65	48	40	M10	M10	74	65	230	77.5	65	70	115	GN 911-M10M55	GN 911-M10-63	1270
GN.65831	GN.65836	GN 288-B48-B42-T-2-*	65	48	42	M10	M10	74	65	230	77.5	65	70	115	GN 911-M10M55	GN 911-M10-63	1265
GN.65871	GN.65876	GN 288-B48-B45-T-2-*	65	48	45	M10	M10	74	65	230	77.5	65	70	115	GN 911-M10M55	GN 911-M10-63	1260
GN.65911	GN.65916	GN 288-B48-B48-T-2-*	65	48	48	M10	M10	74	65	230	77.5	65	70	115	GN 911-M10M55	GN 911-M10-63	1315
GN.65951	GN.65956	GN 288-B48-B50-T-2-*	65	48	50	M10	M10	74	65	230	77.5	65	70	115	GN 911-M10M55	GN 911-M10-63	1295
GN.65991	GN.65996	GN 288-B50-B40-T-2-*	65	50	40	M10	M10	74	65	230	77.5	65	70	115	GN 911-M10M55	GN 911-M10-63	1275
GN.66031	GN.66036	GN 288-B50-B42-T-2-*	65	50	42	M10	M10	74	65	230	77.5	65	70	115	GN 911-M10M55	GN 911-M10-63	1275
GN.66071	GN.66076	GN 288-B50-B45-T-2-*	65	50	45	M10	M10	74	65	230	77.5	65	70	115	GN 911-M10M55	GN 911-M10-63	1270
GN.66111	GN.66116	GN 288-B50-B48-T-2-*	65	50	48	M10	M10	74	65	230	77.5	65	70	115	GN 911-M10M55	GN 911-M10-63	1265
GN.66151	GN.66156	GN 288-B50-B50-T-2-*	65	50	50	M10	M10	74	65	230	77.5	65	70	115	GN 911-M10M55	GN 911-M10-63	1285

* Complete the description of the standard item needed by adding the finish of the connector clamps: BL (blank) or SW (black).